

# Specifications

## 2. Surface mounting procedure

1). Open the lamps, then take out the accessories bag.

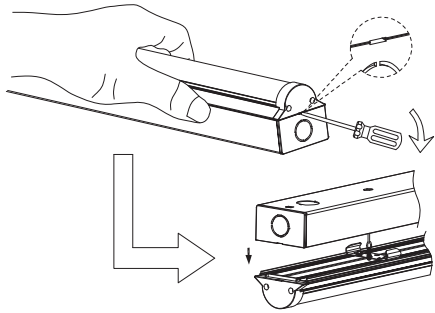

3). Fix the rear aluminium casing to the wall/ceiling.

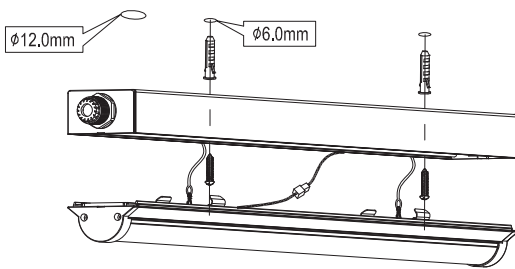

5). Assemble the lamp body on the Aluminum casing.

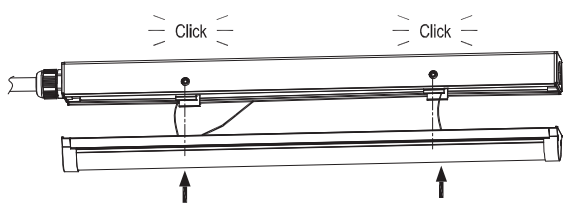

2). Pop out required entry hole, then mount the cable gland.

① Rear entry

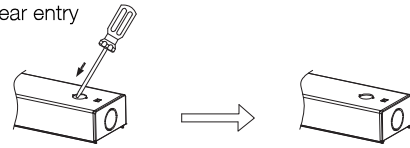

② Side entry

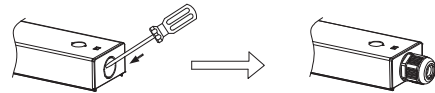

4). Connected the input wire to the terminal like below.

① Rear entry

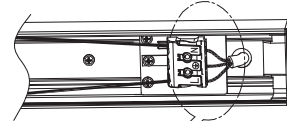

② Side entry

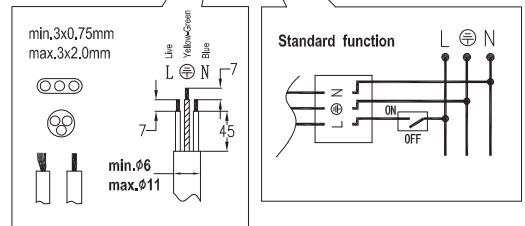
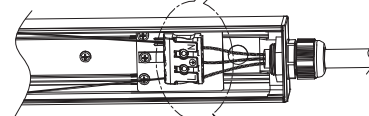

## • Package

Product Type	Rated Power	Inner Box	Outer Carton	Qty/Carton	Unit N.W	G.W/Carton
600mm	10W	608 x 60 x 63mm	625 x 325 x 150mm	10Pcs	500g	6.4Kg
1200mm	18W	1208 x 60 x 63mm	1225 x 325 x 150mm	10Pcs	880g	11.3Kg
1500mm	55W / 30W	1508 x 60 x 63mm	1525 x 325 x 150mm	10Pcs	1080g	14.5Kg
1800mm	32W/ 62W	1808 x 60 x 63mm	1825 x 325 x 150mm	10Pcs	1295g	17.8Kg

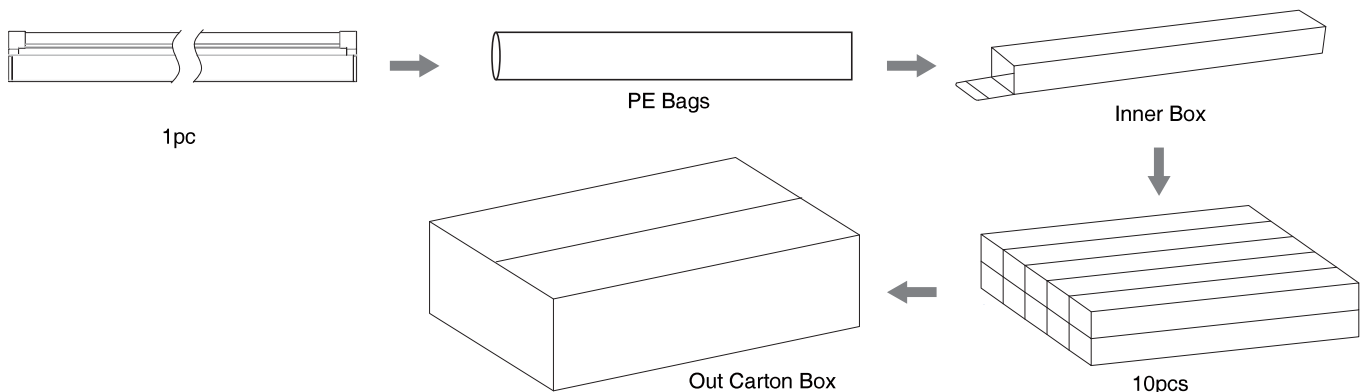

## ! CAUTION

- ※ In case of electric shock, please make sure the power is off when installation is made.
- ※ The lamp should be installed and operated by a qualified electrician or technician in accordance with relevant local codes.
- ※ Do not use sharp tools near or on the surface of the lamp.
- ※ Unpack and carefully examine the product. Report any damage and save all packing materials if any portion of the product was damaged during transportation.